

**KEY PLAN**  
(Scale 1:1250)

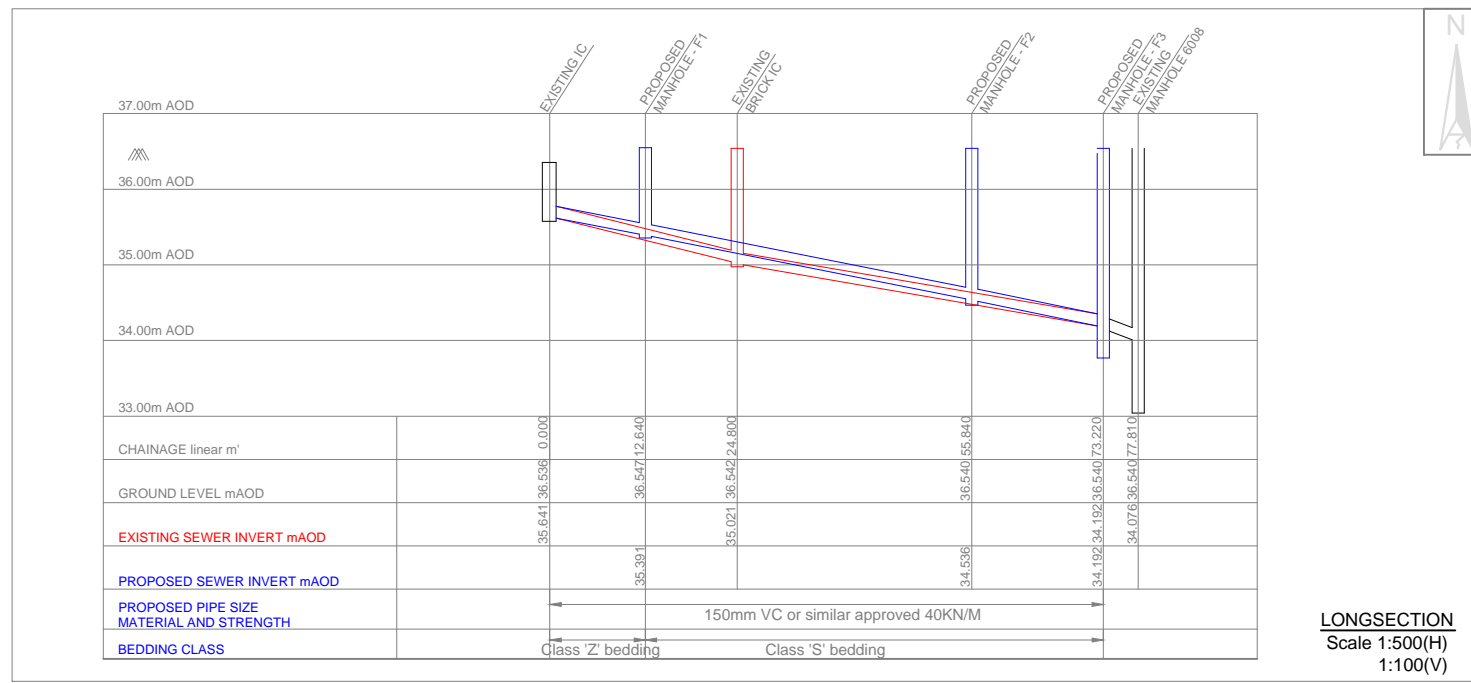

**LONGSECTION**  
Scale 1:500(H)  
1:100(V)

**FOUL MANHOLE SCHEDULE**

MH NO.	COVER LVL (m)	INVERT LVL (m)		DEPTH (m)		MAX PIPE (mm)	MH TYPE
		PROPOSED	EXISTING	PROPOSED	EXISTING		
IC	36.356	35.641	-	0.715	-	150	EXISTING
F1	36.547	35.391	-	1.156	-	150	3
F2	36.540	34.536	-	2.004	-	150	3
F3	36.540	34.192	34.192	2.348	2.348	150	3

**TYPICAL INSPECTION CHAMBER DETAILS- TYPE 3 (Rigid material detail)**

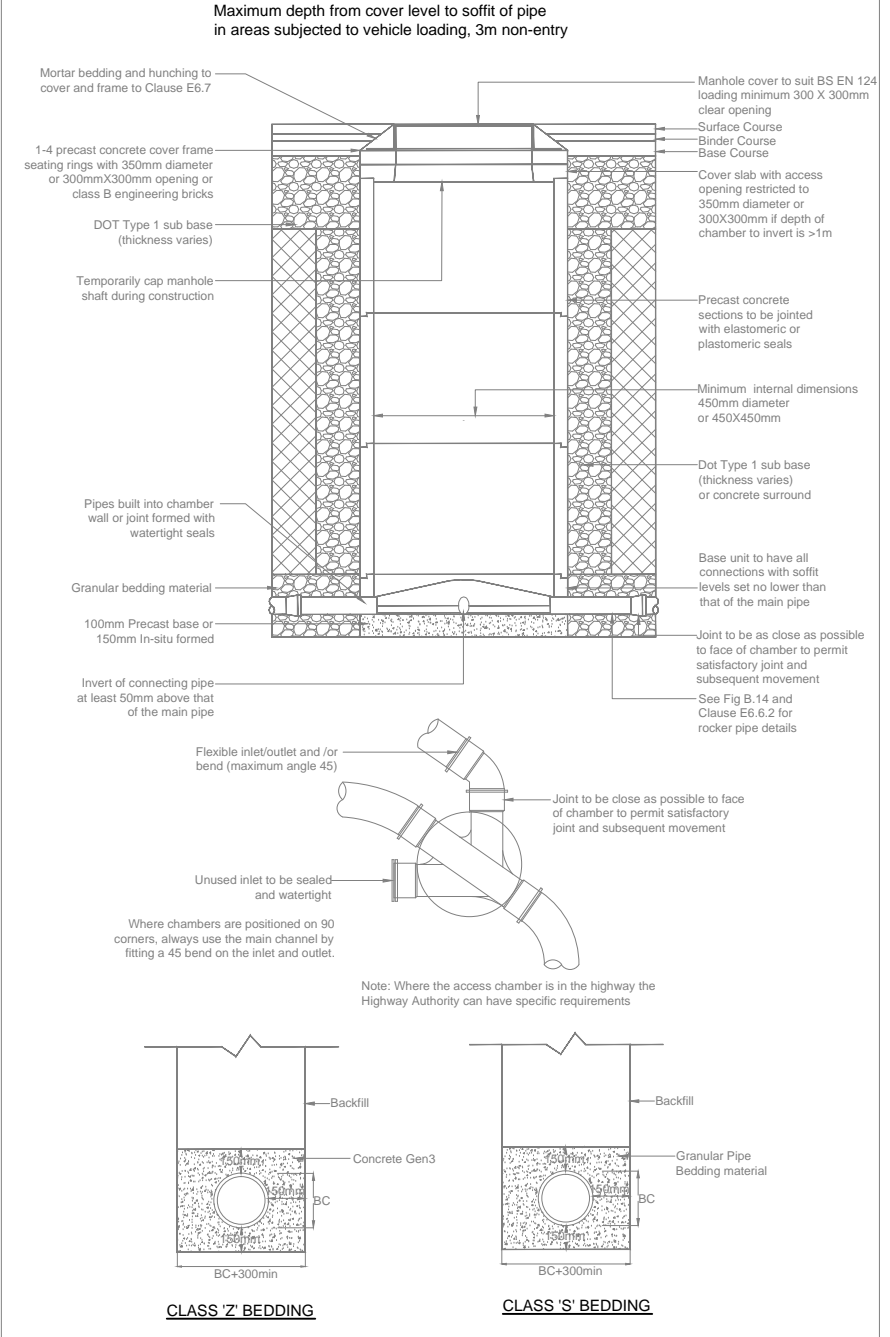

- Notes**
- Do not scale from this drawing. Use figured dimensions only.
  - All levels are given in metres above ordnance datum (mAOD)
  - All dimensions are given in metres
  - All works to comply with Sewers for Adoption (6th or 7th edition to be mentioned by the developer)
  - Sewer to be abandoned should be removed from ground not grouted up
  - Easements are not required where the gravity sewer is less than 300mm diameter and less than 3m deep or in the public highway
  - The shown MH details is a typical MH and reference should be made to Sewers for Adoption for the appropriate MH's for your diversion
  - Class Z bedding to be identified when cover depth is not achievable as per the standards
  - Soakaway should be minimum 5m away from the proposed sewers

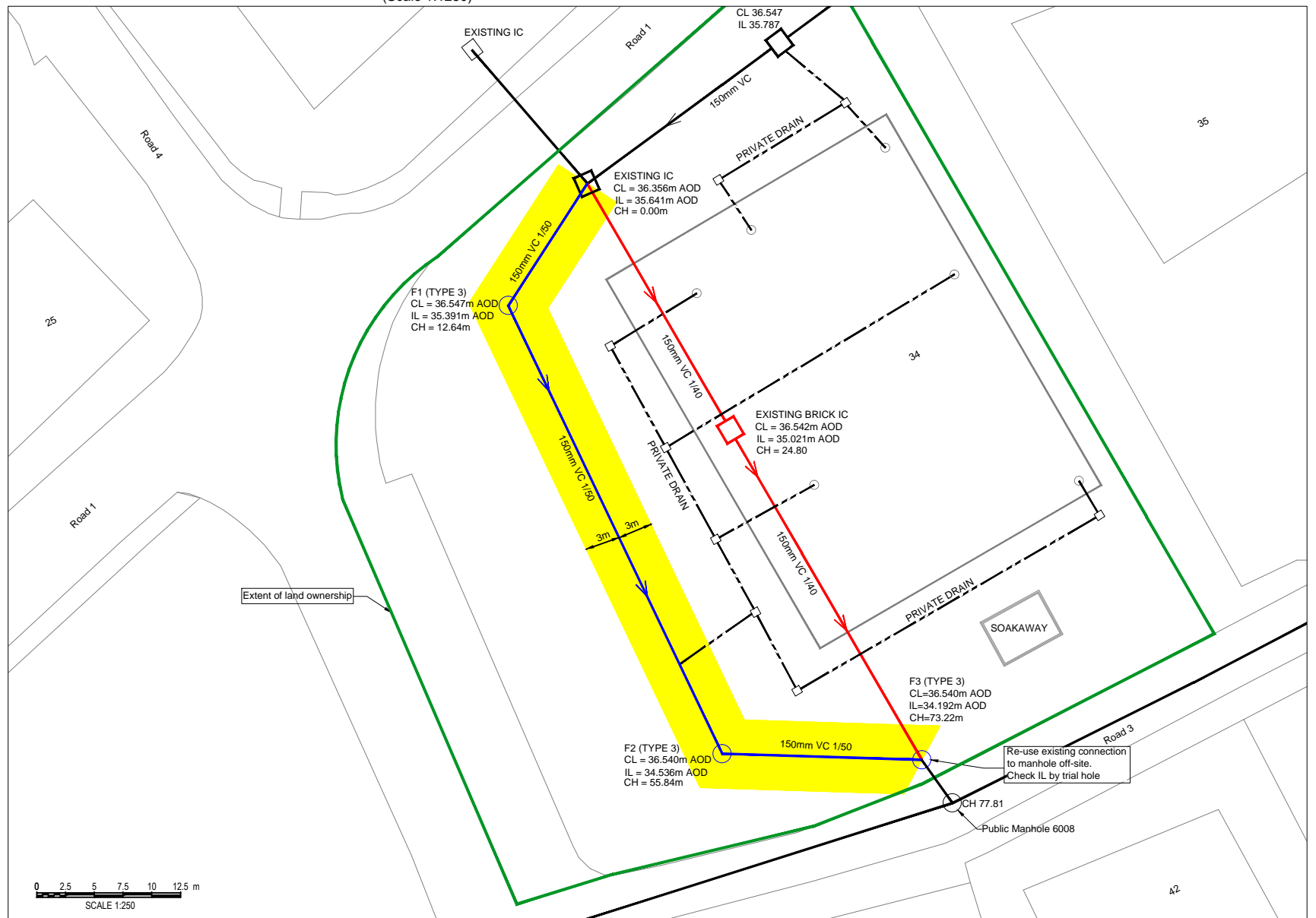

**DETAIL-A : PROPOSED WORKS**

Site Layout based on developer's drawing

- LEGEND:**
- EXISTING SEWER
  - PRIVATE DRAIN
  - PROPOSED SEWER
  - PROPOSED MANHOLE
  - EXISTING SEWER TO BE REMOVED
  - EXISTING BRICK IC
  - EASEMENT
  - BACKDROP MANHOLE

DRAWING NO	S104/185-01
SCALE	1:250 @ A1
DATE	Aug 2015
DRAWING NAME	MINIMUM STANDARD OF DRAWING REQUIRED FOR A S104/185 SUBMISSION